

# INSTRUCTION

## Device Activation



Thanks for using ellenex solutions to simplify your asset monitoring. Your device is pre-configured, and you just need to follow simple steps to get the sensor operational in your account.

### 1- INSTALL THE SENSOR

Please follow the product specific instruction or industry standards to install the sensor. Depends on the sensor type, you can use the rod mount, mounting bracket, install the sensor directly on the wall or industrial assets. For more information visit our website by scanning the QR code, or contact our technical support team.



### 2- TURN ON THE DEVICE

Press the on/off switch.

Note: If you ordered a device without on/off switch, you need to open the device cap and connect the jumper as instructed.

### 3- ACTIVATION

You don't need any specific setup or programming to activate the device. Just follow the diagram on the next page.

You should see the reading of the device on the platform or the app.

### 4- ANY QUESTION?

Send us an email on [Support@LPWAN.Group](mailto:Support@LPWAN.Group) and we will take care of the rest.



# INSTRUCTION

## Device Activation

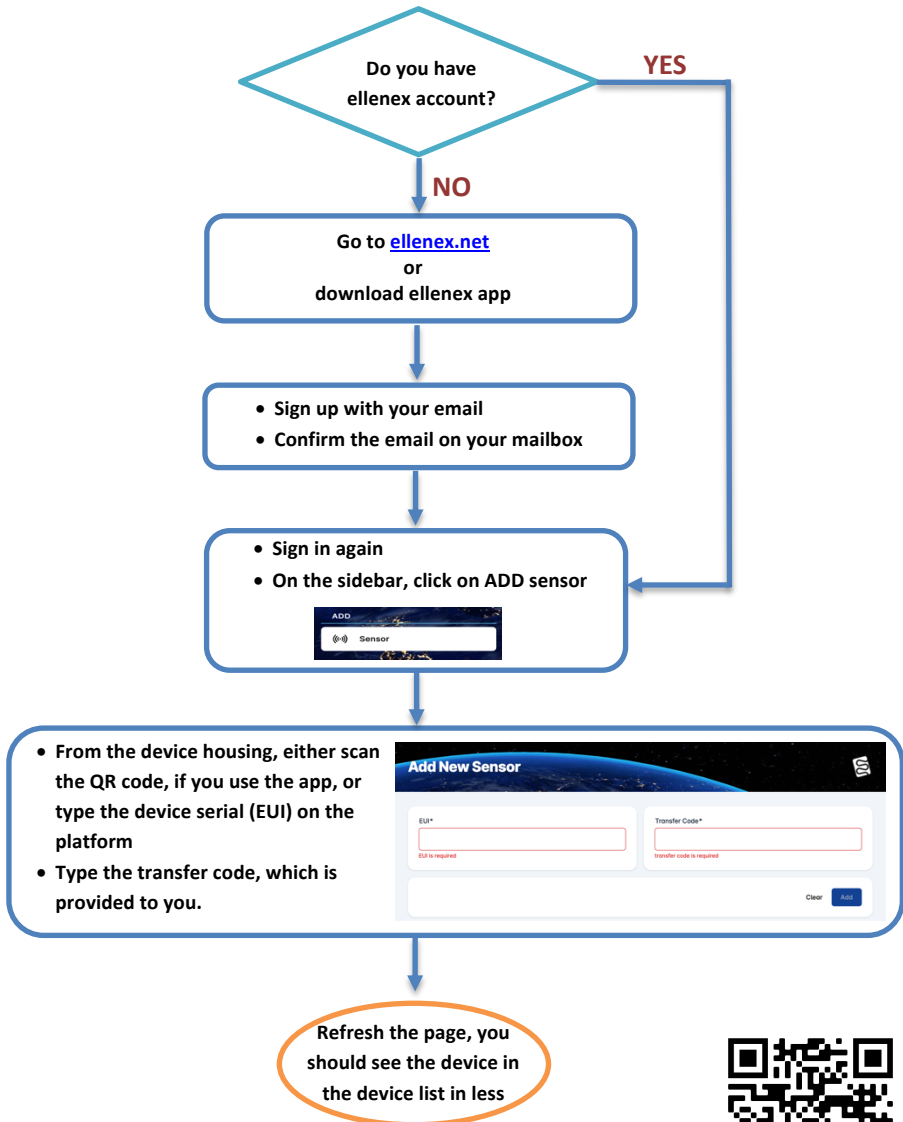

Scan the QR code for more information on the platform features and operation

